

NORMA DIN 908 type

TYPE	CODE	GAS	e	g	h	f	t	d
<b>TCCEM0G</b>	1GTEM00A	1/8"	5	5	4	8	3	14
<b>TCCEM1G</b>	1GTEM10A	1/4"	6	5	5	12	3	18
<b>TCCEM2G</b>	1GTEM20A	3/8"	8	5	5	12	3	22
<b>TCCEM3G</b>	1GTEM30A	1/2"	10	6	5	14	4	26
<b>TCCEM4G</b>	1GTEM40A	3/4"	12	10	6	16	4	32
<b>TCCEM5G</b>	1GTEM50A	1"	17	10	6	16	5	40
<b>TCCEM6G</b>	1GTEM60A	1" 1/4	22	15	10	16	5	49
<b>TCCEM7G</b>	1GTEM70A	1" 1/2	24	15	10	16	5	55
<b>TCCEM8G</b>	1GTEM80A	2"	32	15	15	20	5	68

# TCCEM

## Magnetic oil - drain plug with hex slot

- ▶ Made of tempered, hardened alloy.
- ▶ A permanent magnetic insert of special alloy attracts and holds ferrous particles suspended or circulating in the oil.
- ▶ Especially recommended for high-rpm machinery.
- ▶ Available with metal washers only.

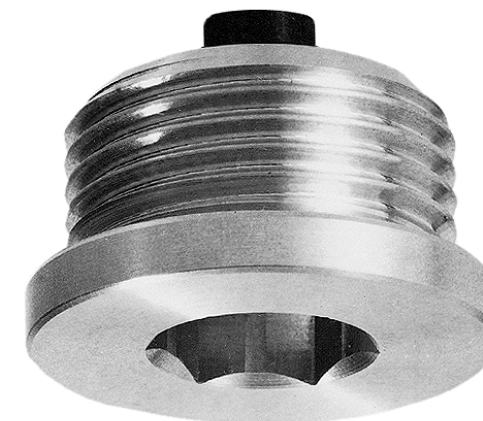

PRINTING NOTES

PRINT

TYPE	COD•	MB series	e	g	h	f	t	d
<b>TCCEM0M</b>	1MTEM00A	10 x 1	5	5	4	8	3	14
<b>TCCEM1M</b>	1MTEM10A	12 x 1,5	6	5	4	12	3	17
<b>TCCEM2M</b>	1MTEM20A	14 x 1,5	6	5	5	12	3	19
<b>TCCEM3M</b>	1MTEM30A	16 x 1,5	8	5	5	12	3	21
<b>TCCEM4M</b>	1MTEM40A	18 x 1,5	8	6	5	12	3	23
<b>TCCEM5M</b>	1MTEM50A	20 x 1,5	10	6	5	14	4	25
<b>TCCEM6M</b>	1MTEM60A	22 x 1,5	10	6	5	14	4	27
<b>TCCEM7M</b>	1MTEM70A	24 x 1,5*	12	6	5	14	4	29
<b>TCCEM8M</b>	1MTEM80A	24 x 2	12	6	5	14	4	29
<b>TCCEM9M</b>	1MTEM90A	26 x 1,5*	12	10	6	16	4	32
<b>TCCEM10M</b>	1MTEM91A	27x 2	12	10	6	16	4	32
<b>TCCEM11M</b>	1MTEM92A	30 x 1,5*	17	10	6	16	4	36
<b>TCCEM12M</b>	1MTEM93A	30x 2	17	10	6	16	4	36
<b>TCCEM13M</b>	1MTEM94A	33x 2	17	10	6	16	5	40

The articles marked \* are extra-table.